

Cast Malleable Iron Wire Rope Clip

Plain Finish, for 3/16" Rope Diameter

30325T62



| | |
|---------------------------|--------------------------------|
| For Rope Diameter | 3/16" |
| Minimum Clips Required | 3 |
| Rope Turnback | 5 1/2" |
| Torque | 4.5 ft.-lbs. |
| Additional Specifications | Malleable Iron Plain Finish |

The choice when the extra strength of forged clips is not required. All are single saddle.

Clips are good for applications where corrosion is not a factor. All meet Fed. Spec. FF-C-450.

Warning! Do not use with coated wire rope unless coating is removed.

MALLEABLE WIRE ROPE CLIPS

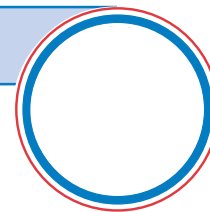

Clips supplied with self-colored, galvanized or hot galvanized finish. U-bolts for clips are available with or without nuts — price on application.



Should be used
only in
light duty applications

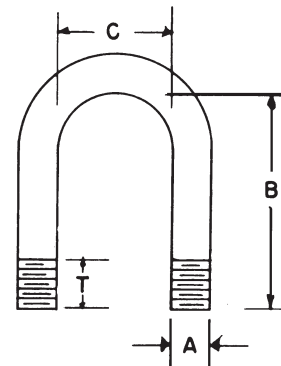

Meets Performance Requirements of Federal Specification FF-C-450, Type 1, Class 2

| Rope Size | Self-Colored | Galvanized | Hot Galvanized | U-Bolt Dimensions | | | | Weight |
|-----------|--------------|------------|----------------|-------------------|----------|----------|--------|---------|
| | Part No. | Part No. | Part No. | A | B | C | T | Per 100 |
| 3/32" | 23005 6 | 23155 8 | N.A. | 10-24 | 3/4" | 19/64" | 1/2" | 3.7 |
| 1/8" | 23010 0 | 23160 2 | N.A. | 1/4"-20 | 15/16" | 5/16" | 5/8" | 6.5 |
| 3/16" | 23015 5 | 23165 7 | N.A. | 1/4"-20 | 15/16" | 5/16" | 5/8" | 6.8 |
| 1/4" | 23020 9 | 23170 1 | 23320 0 | 5/16"-18 | 1-5/32" | 3/8" | 3/4" | 12.2 |
| 5/16" | 23025 4 | 23175 6 | 23325 5 | 5/16"-18 | 1-5/32" | 3/8" | 3/4" | 12.2 |
| 3/8" | 23030 8 | 23180 0 | 23330 9 | 3/8"-16 | 1-1/2" | 1/2" | 1" | 18.5 |
| 7/16" | 23035 3 | 23185 5 | 23335 4 | 3/8"-16 | 1-1/2" | 1/2" | 1" | 24 |
| 1/2" | 23040 7 | 23190 9 | 23340 8 | 7/16"-14 | 1-13/16" | 9/16" | 1-1/8" | 33.3 |
| 9/16" | 23045 2 | 23195 4 | 23345 3 | 1/2"-13 | 2-1/8" | 11/16" | 1-3/8" | 51.5 |
| 5/8" | 23050 6 | 23200 5 | 23350 7 | 1/2"-13 | 2-1/8" | 11/16" | 1-3/8" | 55.9 |
| 3/4" | 23055 1 | 23205 0 | 23355 2 | 9/16"-12 | 2-11/16" | 13/16" | 1-5/8" | 80.8 |
| 7/8" | 23060 5 | 23210 4 | 23360 6 | 5/8"-11 | 3-1/4" | 1-1/8" | 1-7/8" | 140 |
| 1" | 23065 0 | 23215 9 | 23365 1 | 5/8"-11 | 3-1/4" | 1-1/8" | 1-7/8" | 150 |
| 1-1/8" | 23070 4 | 23220 3 | N.A. | 3/4"-10 | 4-3/8" | 1-5/16" | 2-1/2" | 263 |
| 1-1/4" | 23075 9 | 23225 8 | N.A. | 3/4"-10 | 4-3/8" | 1-5/16" | 2-1/2" | 300 |
| 1-3/8" | 23080 3 | 23230 2 | N.A. | 7/8"-9 | 5-1/8" | 1-11/16" | 2-3/4" | 441 |
| 1-1/2" | 23085 8 | 23235 7 | N.A. | 7/8"-9 | 5-1/8" | 1-11/16" | 2-3/4" | 488 |
| 1-3/4" | 23095 7 | 23245 6 | N.A. | 1"-8 | 6-1/4" | 2-1/16" | 3-3/4" | 899.5 |
| 2" | 23100 8 | 23250 0 | N.A. | 1"-8 | 7-1/4" | 2-1/2" | 4" | 1285 |